

**ALT BID #4 MECHANICAL FLOOR PLAN**

SCALE: 1/8" = 1'-0"

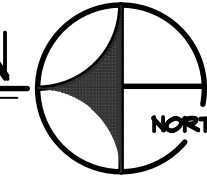

**KEY PLAN:**

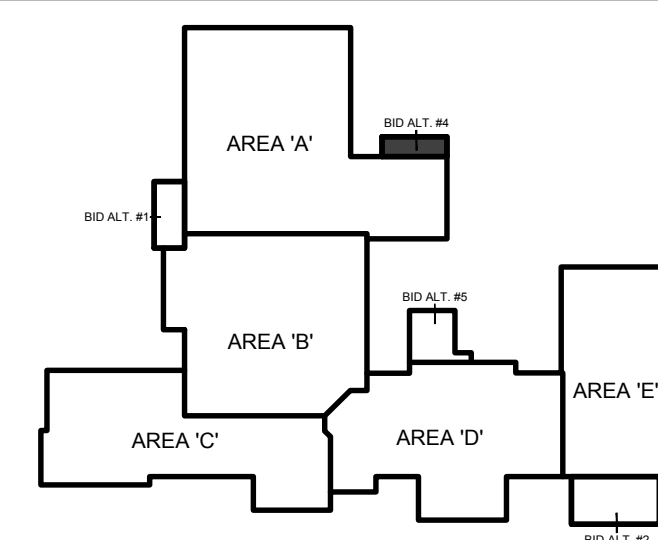

**PLAN NOTES:**

- ① MOUNT ELECTRIC UNIT HEATER TO WALL ABOVE DOORWAY WITH WALL BRACKET. REFER TO DETAIL D/M3.1 FOR TYPICAL INSTALLATION AND MOUNTING. MOUNT THERMOSTAT ON UNIT.

**BID SET**

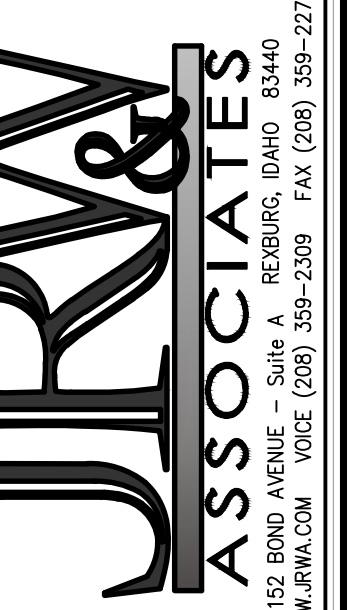
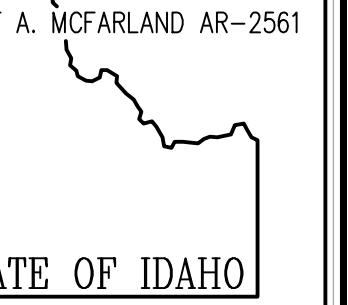

**CONSULTANTS:**

- LANDSCAPE ARCHITECT**  
HEWNER & ASSOCIATES  
1605 South Woodruff  
Idaho Falls, Idaho 83404  
(208) 528-9004
- CIVIL ENGINEERING**  
CONNECT ENGINEERING  
1120 Halpin Dr.  
Idaho Falls, Idaho 83405  
(208) 681-8590
- STRUCTURAL ENGINEERING**  
FROST STRUCTURAL ENGINEERING  
1020 Lincoln Road  
Idaho Falls, Idaho 83401  
(208) 227-4604  
Fax (208) 227-8405
- MECHANICAL ENGINEERING**  
ENGINEERED SYSTEMS ASSOC.  
1355 East Center Street  
Pocatello, Idaho 83204  
(208) 233-0501  
Fax (208) 233-0529
- ELECTRICAL ENGINEERING**  
PAYNE ENGINEERING INC.  
1823 East Center St.  
Pocatello, Idaho 83201  
(208) 232-4439  
Fax (208) 232-1435

**SUGAR - SALEM**  
SD #322  
JUNIOR HIGH SCHOOL

SUGAR CITY  
IDAHO

DRAWING TITLE:  
**BID ALT #4 MECHANICAL FLOOR PLANS**

**REVISION:**

#	DATE	COMMENT

DRAWN BY: M. JENSEN JOB NO: 764

CHECKED BY: D. SUDNEEKS DATE: APR '20

PLOT DATE: Apr 06, 2020

DRAWING NO. M7.4

OF 17

ORIGINAL DRAWING SIGNED BY: DWAYNE C. SUDNEEKS  
DATE ORIGINAL SIGNED: Mar 05, 2020  
ORIGINAL ON FILE AT ENGINEERED SYSTEMS ASSOCIATES  
1355 EAST CENTER, POCATELLO, IDAHO 83201

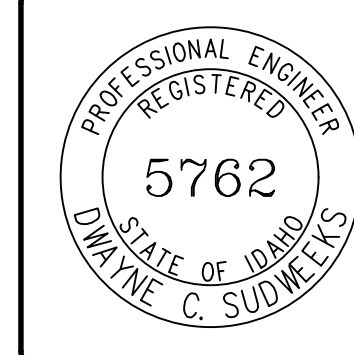

**Engineered Systems Associates**  
1355 EAST CENTER  
POCATELLO, IDAHO 83201  
PHONE: (208) 233-0501  
FAX: (208) 233-0529  
EMAIL: esa@engsystems.com  
ESA JOB NUMBER: 19099

TRV & ASSOCIATES, PLLC. DRAWINGS AND DESIGNS ARE PROTECTED BY COPYRIGHT AND THE ARCHITECT RETAINS TOTAL OWNERSHIP AND CONTROL. ANY UNAUTHORIZED USE OF DRAWINGS, DESIGNS OR IDEAS WITHOUT WRITTEN CONSENT OF THE ARCHITECT ARE PROHIBITED.