

ALT BID #2 MECHANICAL FLOOR PLAN

SCALE: 1/8" = 1'-0"

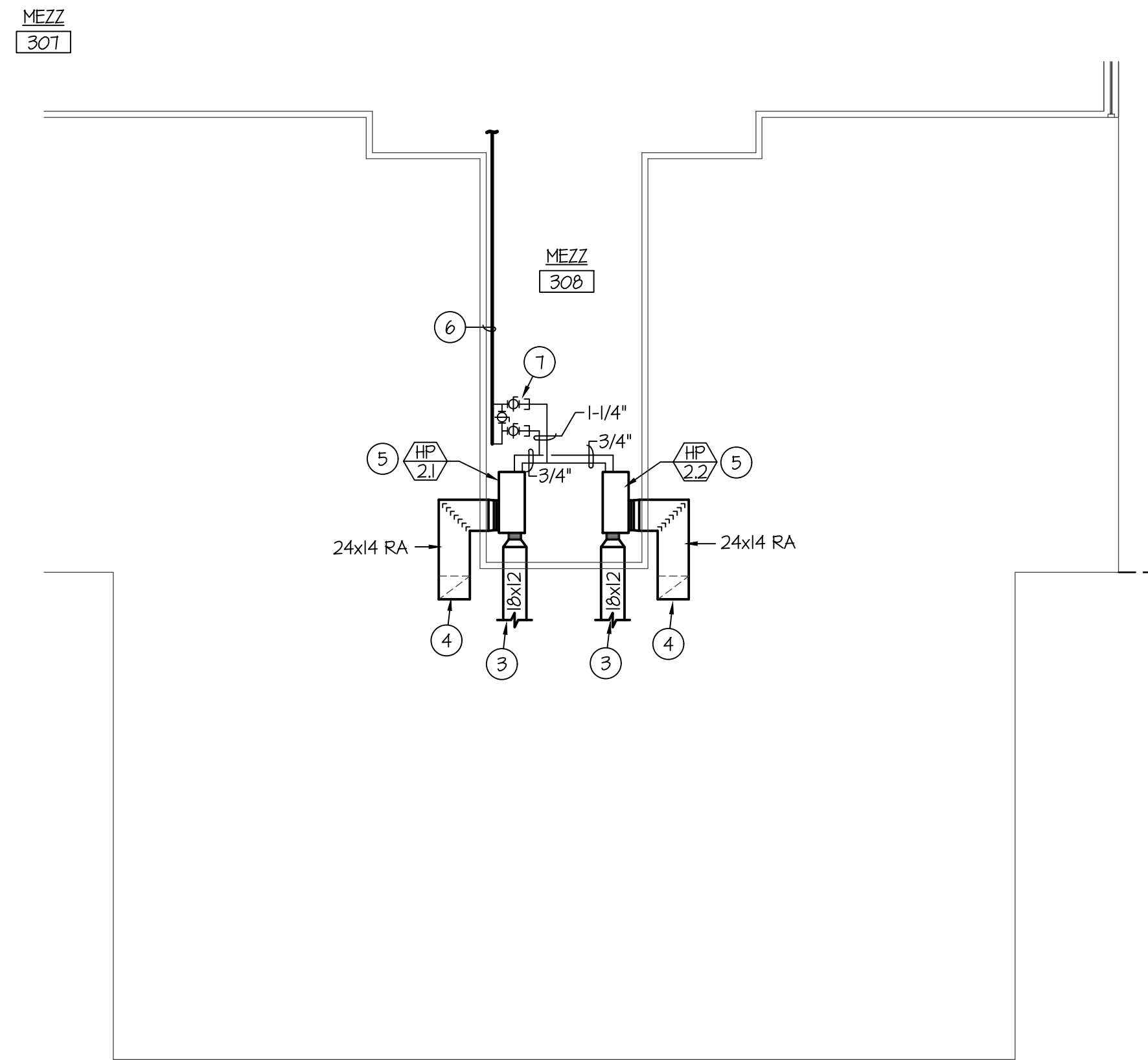
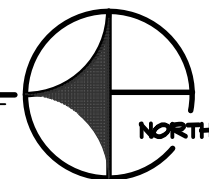

ALT BID #2 MEZZANINE MECHANICAL PLAN

SCALE: 1/8" = 1'-0"



PLAN NOTES:

- 1 REFER TO MEZZANINE WALKWAY LOCATED (THIS SHEET) FOR CONTINUATION OF DUCTWORK.
- 2 MOUNT RETURN GRILLE AT 6" ABOVE FLOOR. RISE 24x14 RETURN AIR DUCT UP IN CHASE, REFER TO MEZZANINE WALKWAY FOR CONTINUATION OF DUCT AND CONNECTION TO CORRESPONDING HEAT PUMP.
- 3 REFER TO FLOOR PLAN (THIS SHEET) FOR CONTINUATION OF DUCTWORK ABOVE ROOMS.
- 4 DROP 24x14 RETURN AIR DUCT DOWN IN CHASE AND CONNECT TO RETURN GRILLE NEAR FLOOR. REFER TO FLOOR PLAN (THIS SHEET) FOR CONTINUATION.
- 5 PROVIDE AND INSTALL WATER SOURCE HEAT PUMP AS SPECIFIED. MOUNT UNIT ON MEZZANINE PLATFORM WITH 2" HIGH SHEET METAL DRAIN PAN. PROVIDE DUCT TRANSITIONS AS REQUIRED TO CONNECT HEAT PUMP. REFER TO SHEET M1.0 FOR HEAT PUMP PIPING. DROP SUPPLY AND RETURN LINES DOWN AT EACH UNIT LOCATION AND CONNECT WITH 2-WAY AUTOMATIC CONTROL VALVE, SHUT-OFF VALVES AND HOSE KITS. REFER TO DETAIL A-M3.2 FOR TYPICAL PIPING CONNECTIONS.
- 6 EXISTING 1-1/4" HEAT PUMP SUPPLY AND RETURN PIPING TO REMAIN. (SEE SHEET M1.0.)
- 7 REMOVE EXISTING CAPS AND EXTEND NEW 3/4" LINES TO NEW HEAT PUMPS. OPEN BY-PASS VALVE AND REMOVE HANDLE.

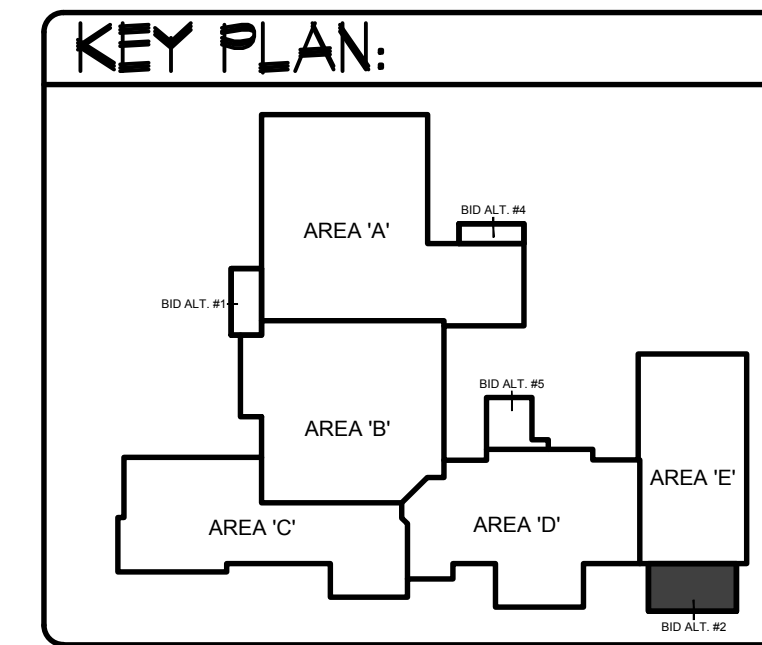

ORIGINAL DRAWING SIGNED BY: DWAYNE C. SUDNEEKS
 DATE ORIGINAL SIGNED: Mar 05, 2020
 ORIGINAL ON FILE AT ENGINEERED SYSTEMS ASSOCIATES
 1355 EAST CENTER, POCATELLO, IDAHO 83201

Engineered Systems Associates
 1355 EAST CENTER
 POCATELLO, IDAHO 83201
 PHONE: (208) 233-0501
 FAX: (208) 233-0529
 EMAIL: esa@engsystems.com
 ESA JOB NUMBER: 19099

PROFESSIONAL ENGINEER REGISTERED 5762 DWAYNE C. SUDNEEKS STATE OF IDAHO

BID SET
 BRENT A. MCFARLAND AR-2561
 STATE OF IDAHO

IRMA & ASSOCIATES
 1152 BOND AVENUE - Suite A REBERG, IDAHO 83440
 WWW.IRMA.COM VOICE (208) 359-2309 FAX (208) 359-2271

- CONSULTANTS:**
- LANDSCAPE ARCHITECT
 MEYER & ASSOCIATES
 1605 South Woodruff
 Idaho Falls, Idaho 83404
 (208) 528-9504
 - CIVIL ENGINEERING
 CONNECT ENGINEERING
 1100 Halpin Dr.
 Idaho Falls, Idaho 83405
 (208) 681-8590
 - STRUCTURAL ENGINEERING
 FROST STRUCTURAL ENGINEERING
 1020 Lincoln Road
 Idaho Falls, Idaho 83401
 (208) 227-4604
 Fax (208) 227-8405
 - MECHANICAL ENGINEERING
 ENGINEERED SYSTEMS ASSOC.
 1355 East Center Street
 Pocatello, Idaho 83204
 (208) 233-0501
 Fax (208) 233-0529
 - ELECTRICAL ENGINEERING
 PAME ENGINEERING INC.
 1823 East Center St.
 Pocatello, Idaho 83201
 (208) 232-4439
 Fax (208) 232-1435

PROJECT: **SUGAR - SALEM**
 SD #322
 JUNIOR HIGH SCHOOL

SUGAR CITY IDAHO

DRAWING TITLE: **ALT BID #2 MECHANICAL FLOOR PLANS**

#	DATE	COMMENT

REVISION:

DRAWN BY: M. JENSEN JOB NO: 764
 CHECKED BY: D. SUDNEEKS DATE: APR '20
 PLOT DATE: Apr 06, 2020

DRAWING NO. M7.2
 OF 17