

ALT BID #1 MECHANICAL FLOOR PLAN

SCALE: 1/4" = 1'-0"

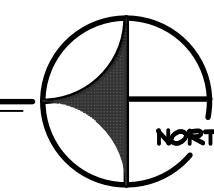

KEY PLAN:

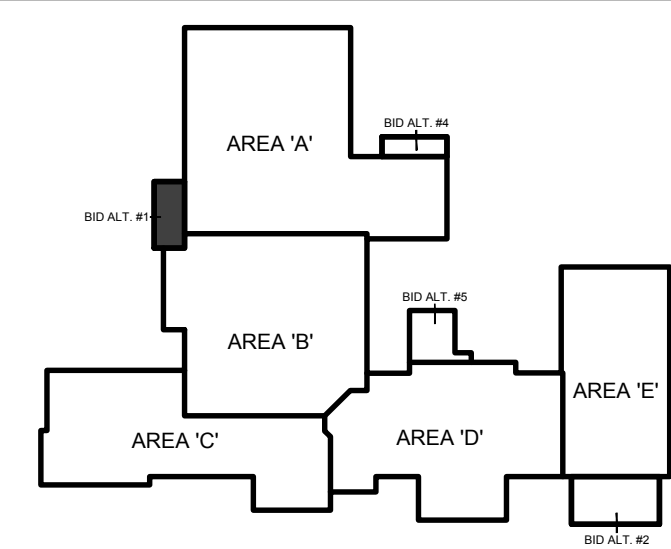

PLAN NOTES:

- 1 PROVIDE AND INSTALL HEAT PUMP UNDER BID ALTERNATE #1. MOUNT UNIT ABOVE STORAGE ROOM CEILING AND RUN DUCTWORK AS SHOWN.
- 2 EXTEND EXISTING 1-1/4" HEAT PUMP SUPPLY AND RETURN PIPING UNDER BID ALTERNATE #1 CONDITIONS AND CONNECT TO HEAT PUMP WITH CONTROL VALVE, SHUT-OFF VALVES AND HOSE KITS. REFER TO DETAIL B.M.B.I. FOR TYPICAL PIPING CONNECTIONS.
- 3 OPEN BYPASS VALVE AND REMOVE HANDLE.
- 4 MOUNT ROOM SENSOR ON WALL AND PROVIDE LOCKING METAL COVER UNDER BID ALTERNATE #1 CONDITIONS.
- 5 ALL GRILLES IN CORRIDOR CEILINGS TO HAVE FIRE DAMPER AT GRILLE. CONNECT TO FIRE ALARM SYSTEM.

BID SET

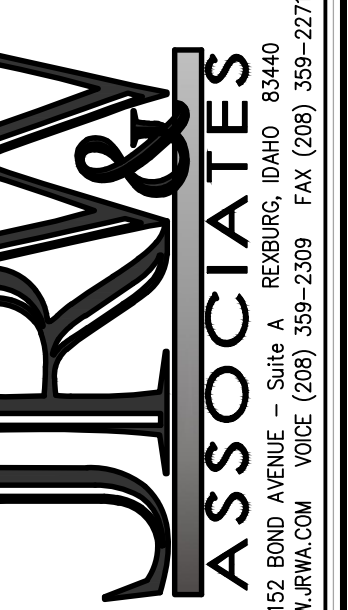
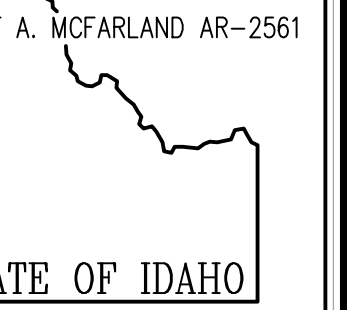

CONSULTANTS:

LANDSCAPE ARCHITECT
 HEAVY & ASSOCIATES
 1605 South Woodway
 Idaho Falls, Idaho 83404
 (208) 528-9004

CIVIL ENGINEERING
 CONNECT ENGINEERING
 1120 Halpin Dr.
 Idaho Falls, Idaho 83405
 (208) 681-8590

STRUCTURAL ENGINEERING
 FROST STRUCTURAL ENGINEERING
 1020 Lincoln Road
 Idaho Falls, Idaho 83401
 (208) 227-4604
 Fax (208) 227-8405

MECHANICAL ENGINEERING
 ENGINEERED SYSTEMS ASSOC.
 1355 East Center Street
 Pocatello, Idaho 83204
 (208) 233-0501
 Fax (208) 233-0529

ELECTRICAL ENGINEERING
 PAME ENGINEERING INC.
 1823 East Center St.
 Pocatello, Idaho 83201
 (208) 232-4430
 Fax (208) 232-1435

PROJECT:
 SUGAR - SALEM
 SD #322
 JUNIOR HIGH SCHOOL

SUGAR CITY
 IDAHO

DRAWING TITLE:
 ALTERNATE #1 MECHANICAL FLOOR PLAN

REVISION:

#	DATE	COMMENT

DRAWN BY: M. JENSEN **JOB NO.:** 764

CHECKED BY: D. SUDNEEKS **DATE:** APR '20

PLOT DATE: Apr 06, 2020

DRAWING NO.: M7.1

FILE: 19099-M7.1.dwg

OF 17

ORIGINAL DRAWING SIGNED BY: DWAYNE C. SUDNEEKS
 DATE ORIGINAL SIGNED: Mar 05, 2020
 ORIGINAL ON FILE AT ENGINEERED SYSTEMS ASSOCIATES
 1355 EAST CENTER, POCATELLO, IDAHO 83201

Engineered Systems Associates
 1355 EAST CENTER
 POCATELLO, IDAHO 83201
 PHONE: (208) 233-0501
 FAX: (208) 233-0529
 EMAIL: esa@engsystems.com
 ESA JOB NUMBER: 19099

