

Mezzanine Plumbing Plan - Area B  
Scale: 1/8" = 1'-0"

Mechanical Floor Plan - Area B  
Scale: 1/8" = 1'-0"

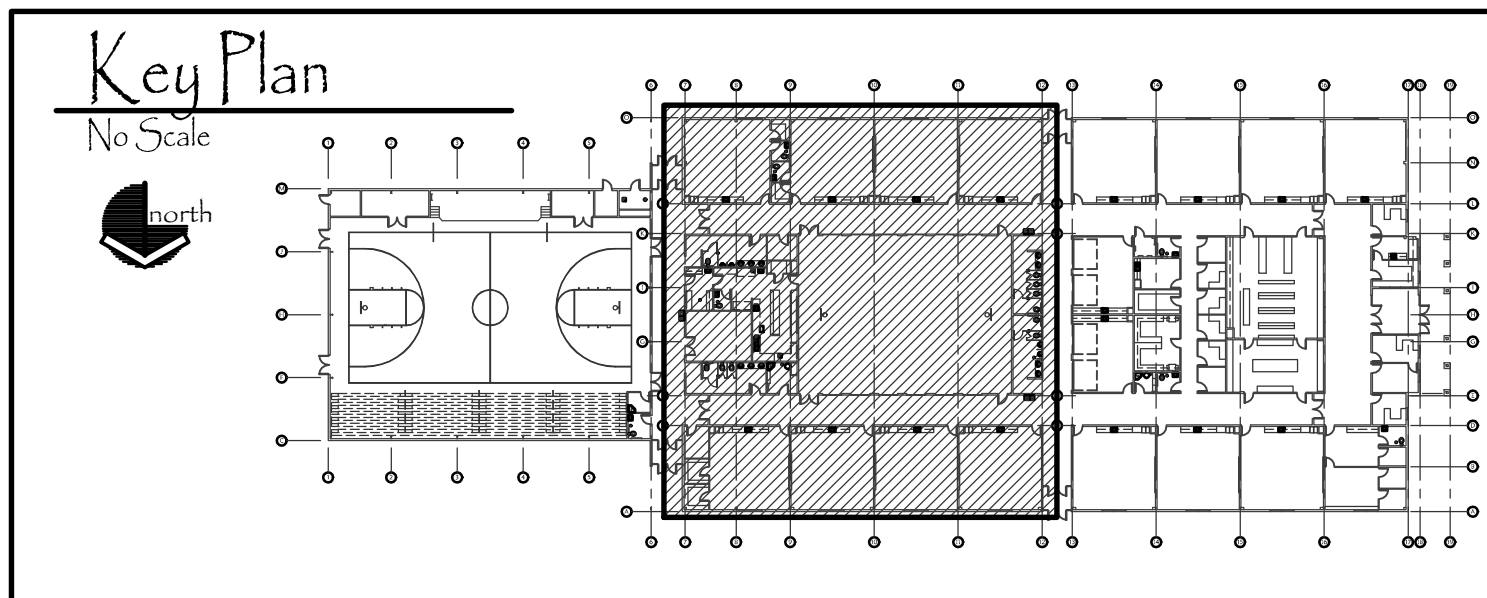

**PLAN NOTES:**

- 1 REFER TO SHEET P1.1 FOR CONTINUATION OF PIPING.
- 2 REFER TO SHEET P1.3 FOR CONTINUATION OF PIPING.
- 3 PROVIDE AND INSTALL GAS FIRED WATER HEATER AS SPECIFIED COMPLETE WITH THERMAL EXPANSION TANK, MIXING VALVE, AND RECIRC. PUMP. REFER TO DETAIL F/P3.1 FOR TYPICAL PIPING CONNECTIONS.
- 4 FURNACE PROVIDED AND INSTALLED BY DIVISION 23. DIVISION 22 TO ROUGH-IN AND CONNECT GAS LINE WITH SHUT-OFF VALVE AND FLEXIBLE HOSE. REFER TO DETAIL A/P3.1 FOR TYPICAL GAS LINE CONNECTION. CONNECT CONDENSATE DRAIN LINE WITH TRAP AND RUN AGAINST WALL AS SHOWN (REFER TO NOTES 14 & 15). REFER TO DETAIL D/P3.1 FOR TYPICAL TRAP INSTALLATION.
- 5 PROVIDE PRESSURE REGULATOR (2 psi TO 5 psi) IN 1-1/2" HIGH PRESSURE GAS LINE. VENT TO OUTSIDE AS RECOMMENDED BY MANUFACTURER. REFER TO DETAIL K/P3.1 FOR TYPICAL INSTALLATION.
- 6 RUN GAS LINE IN CEILING SPACE. COORDINATE WITH DUCTWORK. REFER TO SHEET M1.2 FOR DUCTWORK IN THIS AREA.
- 7 REFER TO MEZZANINE PLUMBING PLAN (THIS SHEET) FOR CONTINUATION OF PIPING.
- 8 PROVIDE TRAP PRIMER AS SPECIFIED BELOW LAVATORY. DROP 1/2" COLD WATER LINE DOWN THRU FLOOR AND CONNECTION TO FLOOR DRAIN IN TOILET ROOM. REFER TO DETAIL K/P3.1 FOR TYPICAL INSTALLATION.
- 9 PROVIDE TRAP PRIMER AS SPECIFIED BELOW LAVATORY. DROP 1/2" COLD WATER LINE DOWN THRU FLOOR FOR EACH FLOOR DRAIN. REFER TO LARGE SCALE PLANS ON SHEET P2.1 AND TO DETAIL J/P3.1 FOR TYPICAL INSTALLATION.
- 10 ENTIRE BUILDING TO BE FIRE SPRINKLED TO MEET NFPA 13 CODE REQUIREMENTS. FIRE SPRINKLER CONTRACTOR TO COORDINATE HEAD AND PIPING LOCATIONS WITH ALL OTHER TRADES. DO NOT LOCATE HEADS AND/OR PIPING OVER ACCESS HATCHES, IN FRONT OF EQUIPMENT CLEARANCE SPACE, BELOW LIGHT FIXTURES, ETC. REFER TO DETAILS ON SHEET P3.2 FOR TYPICAL COORDINATION DISTANCES AND SUPPORTS.
- 11 DROP 3/4" GAS LINE DOWN THRU MEZZANINE FLOOR AND CONNECT TO WATER HEATER BELOW. REFER TO FLOOR PLAN (THIS SHEET) FOR CONTINUATION AND TO DETAIL F/P3.1 FOR TYPICAL PIPE CONNECTION TO FURNACE.
- 12 WATER AND VENT PIPING TO BE RUN THRU CEILING SPACE OF MAIN LEVEL. KEEP MEZZANINE FLOOR CLEAR OF PIPING.
- 13 PROVIDE DRY FIRE SPRINKLER HEADS IN UNHEATED VESTIBULES.
- 14 RUN CONDENSATE DRAIN LINE ALONG MEZZANINE WALLS. KEEP AS HIGH AS POSSIBLE AND GRADE AT 1/4" SLOPE PER FOOT OF LENGTH. SUPPORT PIPING AT 48" MAXIMUM INTERVALS.
- 15 DROP 1-1/4" CONDENSATE DRAIN LINE DOWN THRU MEZZANINE FLOOR. RUN PIPING THRU CEILING SPACE TO JANITOR SINK. REFER TO DETAIL A/P3.3 FOR TYPICAL TERMINATION OF DRAIN LINE IN SINK.
- 16 REFRIGERANT LINES TO RUN THRU CEILING SPACE BY MECHANICAL CONTRACTOR. COORDINATE WITH DUCTWORK. SEE SHEETS M1.1 AND M1.2 FOR CONTINUATION OF LINES AND FOR DUCTWORK.
- 17 REFRIGERANT LINES FURNISHED AND INSTALL BE MECHANICAL CONTRACTOR. LINES SHOWN HERE FOR CLARITY. REFER TO DETAIL A/M1.1 FOR TYPICAL PIPING CONNECTIONS. PIPING TO BE RUN OVER HEAD.

ORIGINAL DRAWING SIGNED BY: DWAYNE C. SUDWEEKS  
DATE ORIGINAL SIGNED: March 20, 2014  
ORIGINAL ON FILE AT ENGINEERS SYSTEMS ASSOCIATES  
1955 EAST CENTER, POCAATELLO, IDAHO 83201

**Engineered Systems Associates**  
1355 EAST CENTER  
POCAATELLO, IDAHO 83201  
PHONE: (208) 233-0501  
FAX: (208) 233-0529  
EMAIL: esa@engsystems.com  
ESA JOB NUMBER: 17078

CONTRACTOR

project for:  
**Grace School District # 148**  
**New Elementary School**  
Fourth West Street  
Grace, Idaho

340 East Clark Street, Suite A  
Pocatello, Idaho 83201  
Phone (208) 233-4548  
Fax (208) 233-0263  
email ted@bootharchitecture.com

**BOOTH**  
Architecture PLLC

Plumbing Floor Plan - Area B  
Date 3/22/19  
Sheet No. P1.2